

19' 1/2" 13' 2 5/8"

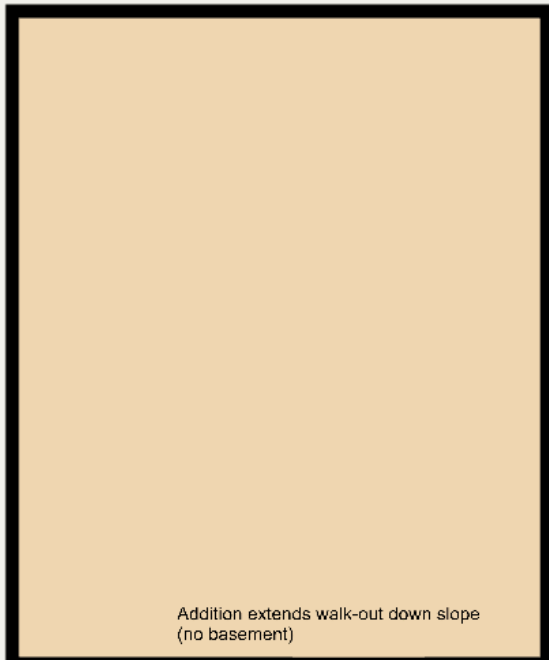

23' 4 1/4"



23' 4 1/4"

Addition extends walk-out down slope (no basement)

12'

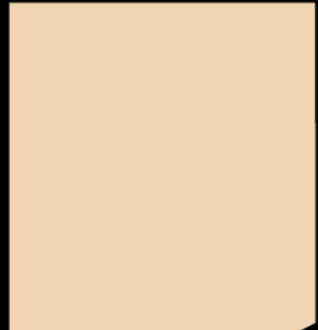

Garage or car port

14' 7 1/2"

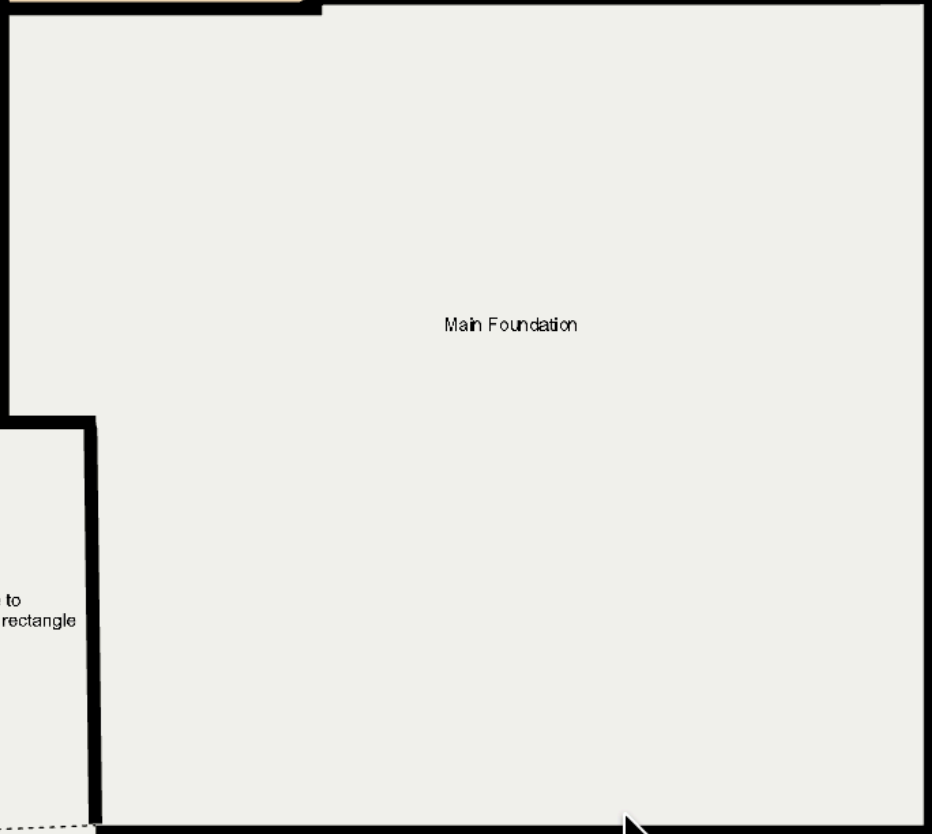

30'

Main Foundation

14' 5"

Might choose to complete the rectangle in the future!



2' 8 5/8"

30' 2 7/8"